

LINX2 Automation Server

LINX-102, LINX-103, LINX-112,
LINX-113, LINX-202, LINX-203,
LINX-212, LINX-213

Installation instructions

Instructions de montage

Istruzioni di montaggio

Montageanweisung

Instrucciones de montaje

Montagevoorschrift

Monteringsanvisning

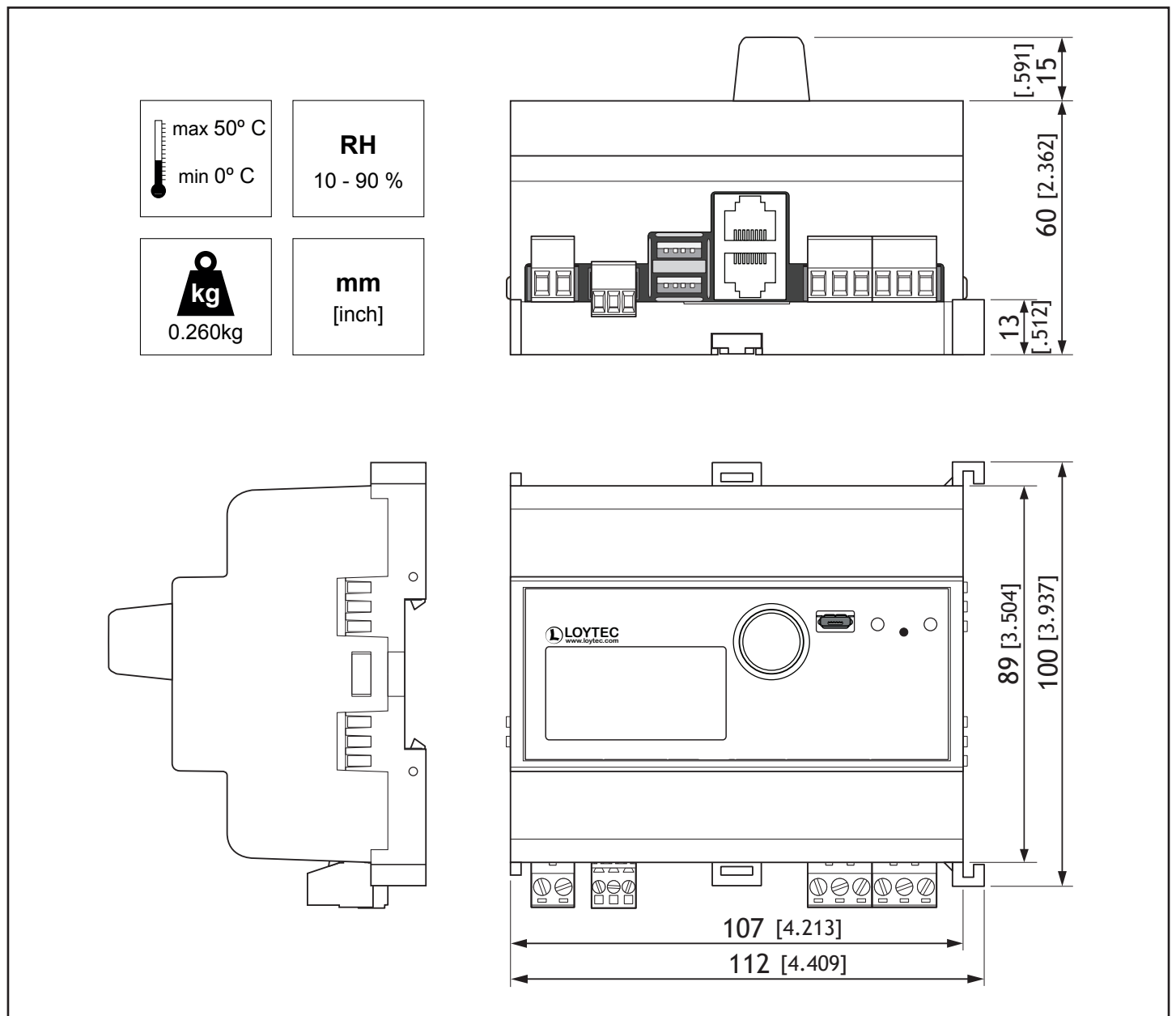

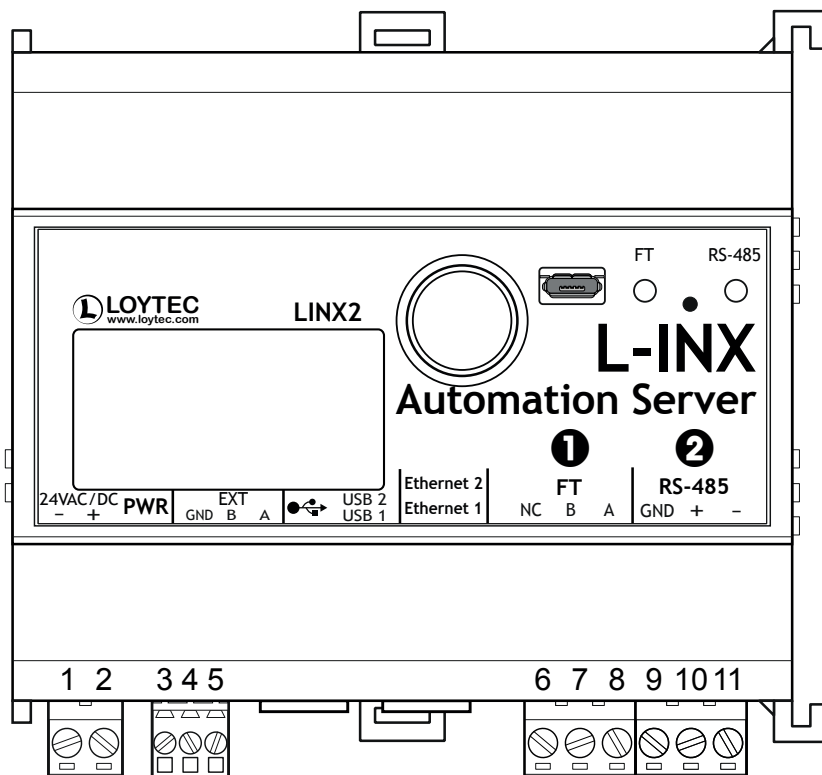

Connectors

POWER	1	Power supply input MINUS
	2	Power supply input PLUS
EXT M-Bus, KNX TP1	3	Input GND
	4	Input B
	5	Input A
TP/FT-10 CEA-709	6	not connected (NC)
	7	Input B
	8	Input A
RS-485 Modbus, BACnet MS/TP	9	Input GND
	10	Input +
	11	Input -

Weidmüller
BL 3.5
0.2 - 1.5 mm²

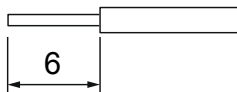

Weidmüller
BLZP 5.08
0.2 - 2.5 mm²

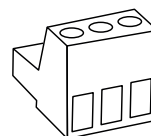
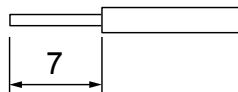

2 poles: Weidmüller BLZP 5.08/02/180
3 poles: Weidmüller BL 3.50/03/180 SN OR BX
3 poles: Weidmüller BLZP 5.08/03/180

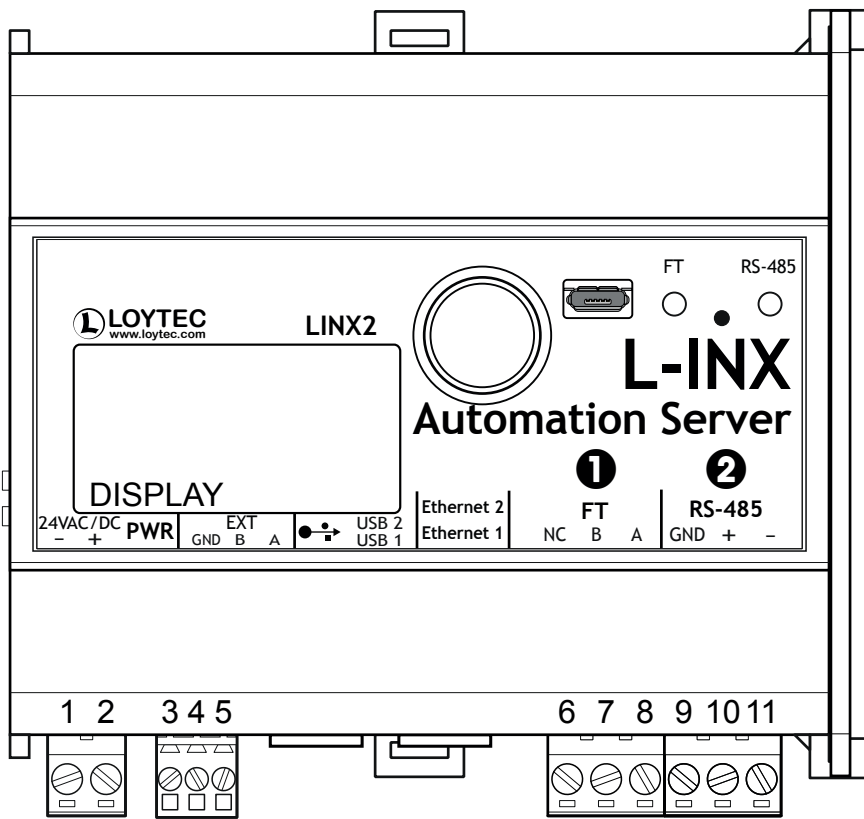

Status LEDs		
FT	GREEN flashing fast GREEN flashing 1 Hz RED permanent RED flashing fast	Traffic on CEA-709 port Not commissioned CEA-709 port damaged CEA-709 traffic overload
RS-485	GREEN flashing RED flashing	Modbus traffic Transmission errors
MODBUS	GREEN flashing fast ORANGE flicker RED permanent RED flashing fast	Token ok, traffic Single master, traffic Token lost, cable damage Communication errors
MS/TP		

Install the cover

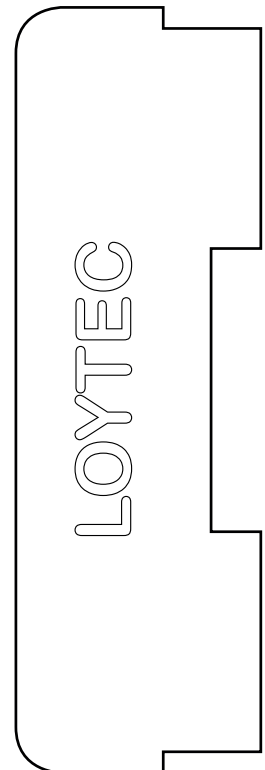

Please update the firmware of the device first,
see www.loytec.com

<http://192.168.1.254>
User: admin
Password: loytec4u

35 mm x 7.5 mm DIN rail (EN 50022, BS 5584, DIN 46277-3)

